

Industrial steam Electric

# Steam Electric Iron

USER MANUAL



## Iron Installation and Operation

### ● Non-Steam Regulator (Sr-3) Type(1)

1. Silver Star card must use the steam pipe, if the use of other brands of steam pipe occurred, the Company does not assume any responsibility.
2. one end is connected to the steam pipe ① boiler or steam valve (2-1) and the other end connected to the inlet connector ③ iron. ⑦ steam pipe connected backwater valve (2-2) on.
3. After confirming iron voltage, the iron on a silica gel plate ⑥, then connect the power, the iron thermostat knob to NO.4, wait about 10 minutes to reach the desired temperature.
4. Open the steam valve, the discharge of water and steam irons inside to begin with.
5. iron during use, for pause operation, must be placed on an iron plate matching silicone ⑥, do not place flammable materials around to avoid fire.
6. When to stop using, first turn off the power, then turn off the steam valve, push valve handle will remain in the iron and the steam pipe ① steam and water is completely drained.
7. irons need to be placed on a silicon plate ⑥ cool at least 30 minutes.

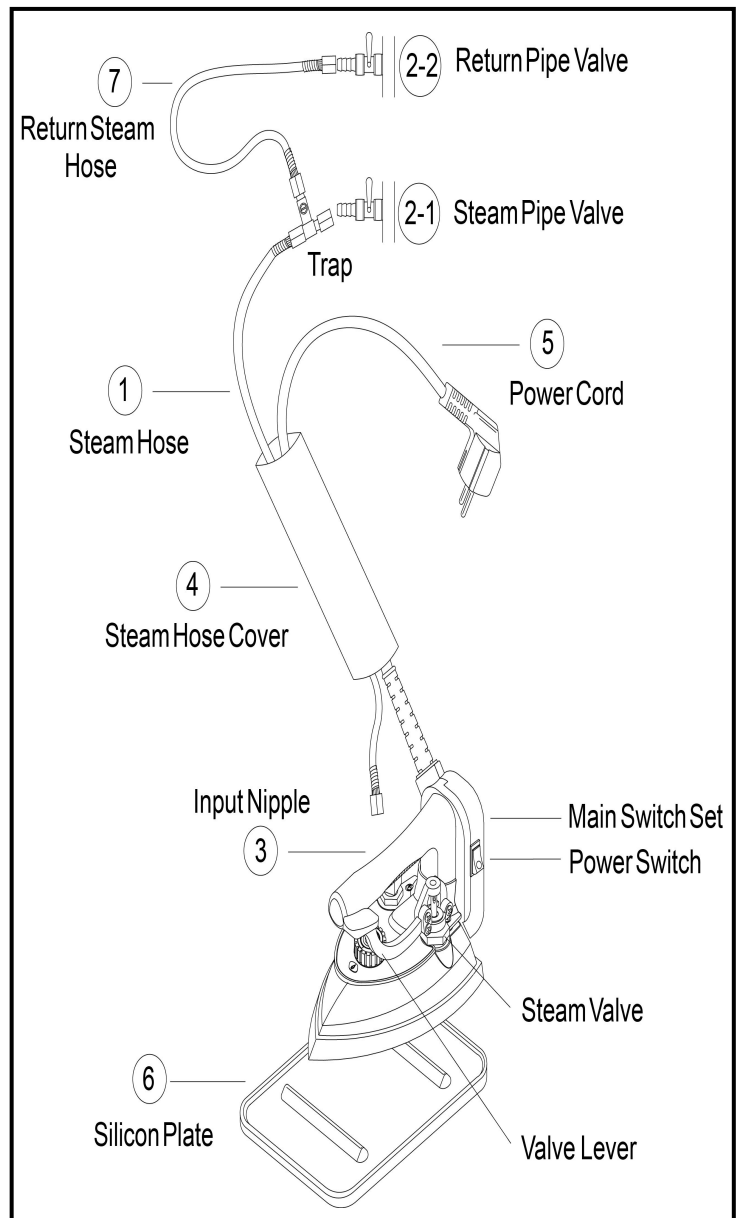

## Iron Installation and Operation

### ● Non-Steam Regulator (Sr-3) Type(2)

1. Use of EunSung's steam hose is strongly recommended. EunSung will not be liable for any problems caused by use of hoses made by manufacturers other than EunSung.
2. Connect one end of steam hose① to boiler or steam pipe valve②, and other end to iron's input nipple③.
3. Check iron's voltage, place iron to Silicon Plate⑥ and connect to power supply. Set iron's control knob to No. 4 and wait around 10 minutes for iron to be heated.
4. Start use after open steam valve to drain steam and water.
5. Always use accompanied Silicon Plate⑥ when placing iron to table while ironing and restrict flammable material close to iron since there is risk of fire.
6. Cut off power, lock steam valve and remove all steam and water remaining inside iron and Steam Hose① after using the iron.

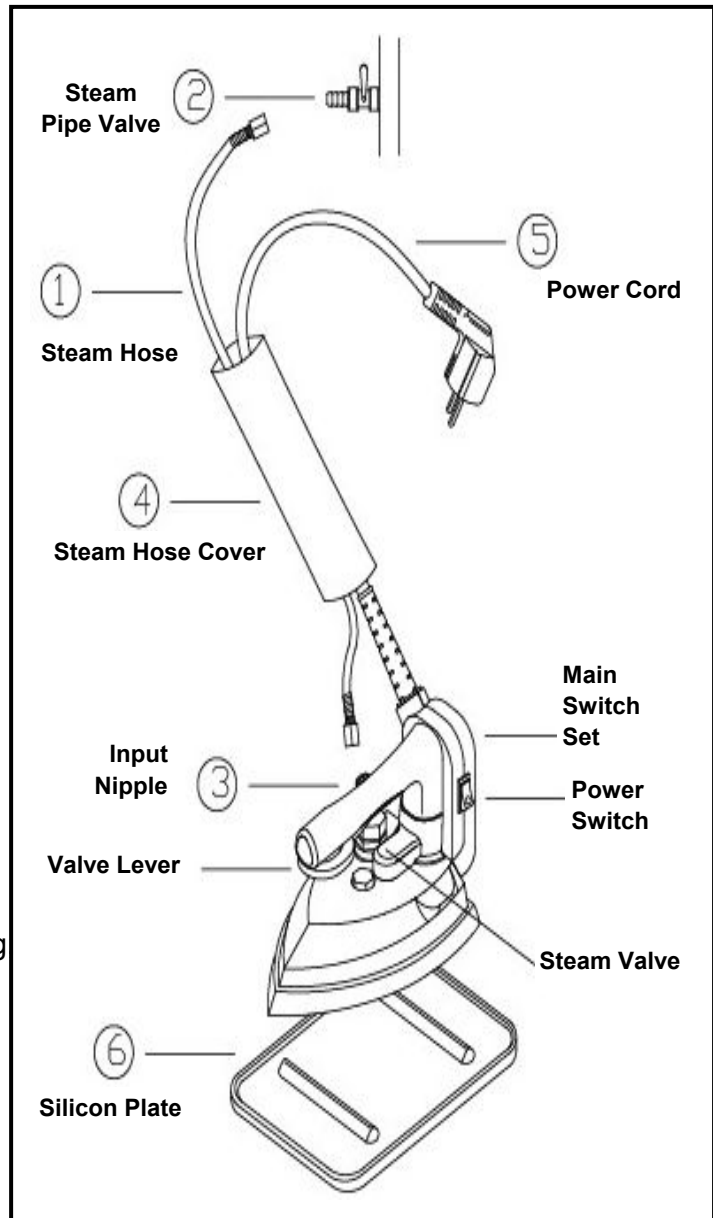

7. Iron shall be cooled down for more than 30 minutes on the Silicon Plate⑥.

### ● Steam Regulator(Sr-3) Type

1. Use of EunSung's steam hose is strongly recommended. EunSung will not be liable for any problems caused by use of hoses made by manufacturers other than EunSung.
2. First, connect Steam Regulator(Sr-3) ① to Boiler or Steam Pipe Valve② (A-A).
3. Connect one end of Teflon Steam Hose③ Steam Regulator (Sr-3) Nipple④, and the other end to iron's Input Nipple⑤. (B-B, C-C)
4. Place iron on the Silicon Plate⑥, check iron and steam regulator (Sr-3) voltages, and connect steam regulator (Sr-3) to power socket and connect iron to steam regulator(Sr-3)'s 4P socket. (D-D)
5. Turn on the power switch of iron and steam regulator (Sr-3). Set iron's Control Knob⑦ to No. 4 and wait around 10 minutes for iron to be heated.

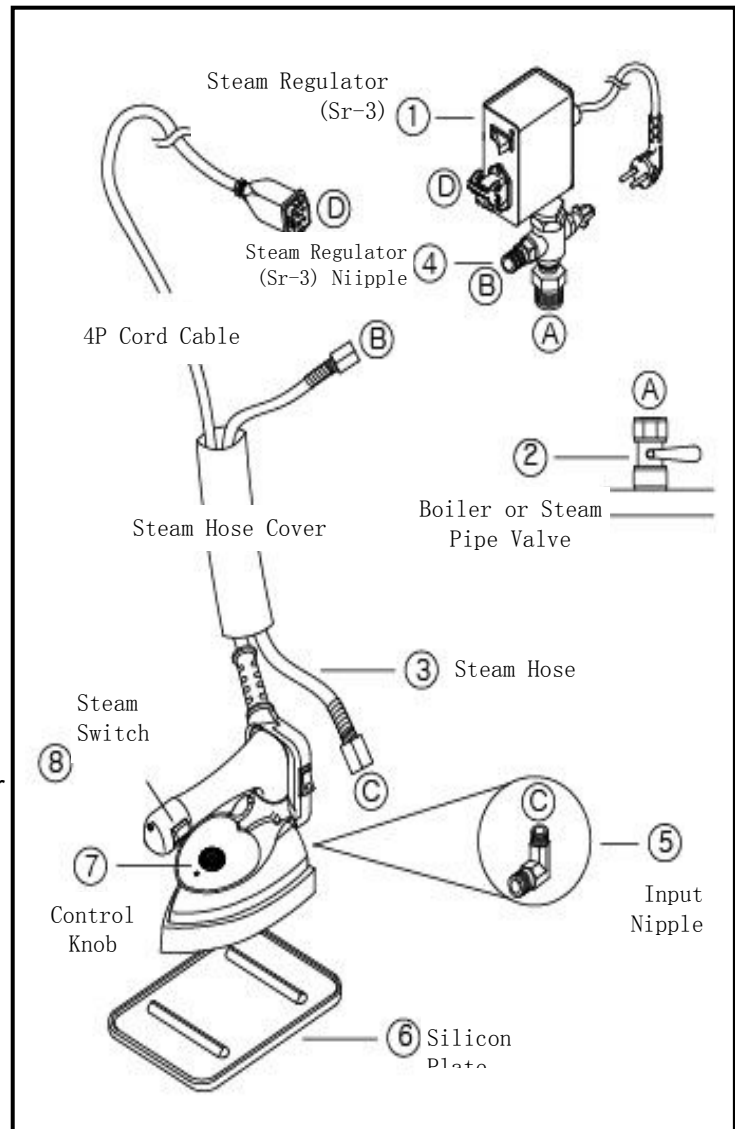

6. Start use after drain steam and water inside iron by pressing Steam Switch⑧.
7. Always use accompanied Silicon Plate⑥ when placing iron to table while ironing, and restrict flammable material close to iron since there is risk of fire.
8. Cut off power supply, lock steam valve, remove steam and water inside iron and Steam Hose① after using the iron.
9. Iron shall be cooled down for at least 30 minutes on the Silicon Plate⑥.



## Safety Regulations

Please observe following safety regulations to prevent danger or accident.

1. Be careful when connecting iron power cord, and check whether iron's indicated voltage matches with power supply socket voltage..
2. Be careful in jointing to prevent steam leakage during use.
3. Check whether there is water or steam inside iron and remove them before using iron.
4. Do not connect multiple plugs to one power socket. There is risk of fire.
5. User shall always be near to iron when using it. Iron's power must be turned off and its plug must be removed from socket when user needs to leave iron for a while.
6. Do not spray iron steam directly to user or to other person's body. There is risk of burn injury.
7. Keep away any part of human body from iron's bottom plate during using it.  
There is a risk of burn injury.
8. Stop use iron and cut off power by disconnecting plug from socket, and contact authorized service center if iron's temperature continues to rise.
9. Stop using iron, disconnect power plug and contact authorized service center when there is any sign or symptom of trouble.
10. If water or other foreign material entered into iron cover, turn off power by disconnecting the plug and inquire authorized service center.
11. Remove iron's power plug from socket when it's lightning or thunders.
12. Do not let children touch or operate iron.
13. Be sure to change power cord from manufacturer or authored service center when it is damaged and need replacement.
14. When steam hose needs replacement, cut off power supply by disconnecting powerplug, lock steam pipe valve, remove steam and water inside iron and steam hose, and wait more than 30 minutes until iron and steam hose are cooled down before replacing the hose.
15. Do not touch or operate inner parts of controller in the iron because they are sensitive parts. There is risk of iron malfunction or fire if it is incorrectly adjusted.
16. Do not touch power cable or operate iron with wet hand. There is risk of electric shock.
17. To clean iron, disconnect power plug from socket and clean it after iron is cooled down.
18. Cut off power supply by disconnecting plug while not in use.
19. Hold power plug when disconnect it from socket. Do not pull power cable to disconnect plug. It is the cause of fire or electric shock by short circuit.
20. Our company does not have liability for any accident that occurred by not observing above safety regulations or any accident caused by any mistakes or carelessness. Also, our company does not have liability for any accident during or after repair of the iron by unauthorized person or at unauthorized place.
21. Please contact our head office or authorized service center if you have any question for product description or trouble.
22. The recommended maximum steam supply pressure for the iron is 5kg/cm<sup>2</sup>.

**Always be sure to observe above safety regulations. Manufacturer does not have liability for any damages caused by ignorance of the safety regulations described above.**

## Size and Specifications

Model	Voltage	Power	Weight	Bottom	Bottom	Surface Treatment
ES-3200N	120V/220V	1300W	2.57kg	208×138	Aluminum	Anodizing/Polishing
ES-3300P	120V/220V	1300W	2.57kg	208×138	Aluminum	Anodizing/Polishing
ES-3300M	120V/220V	1300W	2.48kg	208×138	Aluminum	Anodizing/Polishing
SE-2000	120V/220V	1000W	1.90kg	182×107	Aluminum	Polishing
SE-2000N	120V/220V	1000W	1.90kg	194×107	Aluminum	Polishing
ES-1300M	120V/220V	800W	1.60kg	195×64	Aluminum	Anodizing/Polishing

### ♣ Steam Regulator

Model	Voltage	Weight
Sr-3	120V/220V	1.1kg

## Option Items



Length \ Braid	Dual	Triple	Quadruple
2M	•	•	•
2.5M	•	•	•
3M	•	•	•
4M	•	•	•
5M	•	•	•

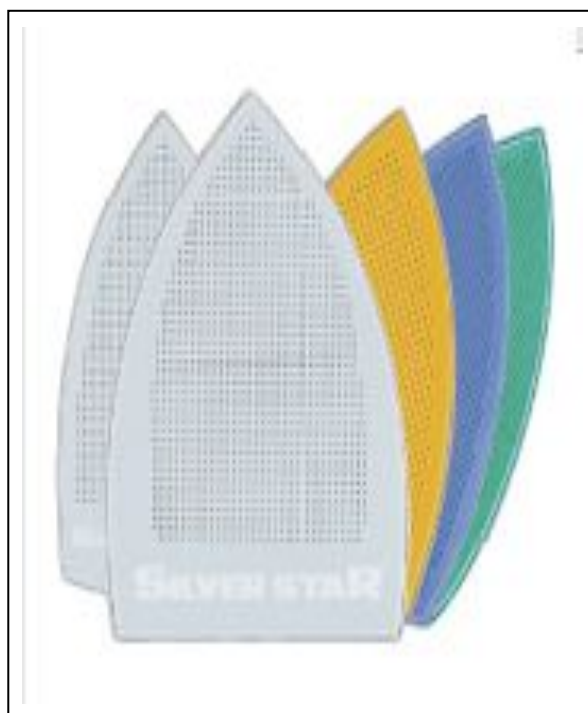

### Steam Hose

- ◎ Sturdy connection method safely holds high internal pressures
- ◎ High quality without deformation even with long period of use
- ◎ Neat and strong processed connector area
- ◎ Convenient zipper type hose cover [sold separately]

### Iron Shoe

- ◆ Use the iron shoe to prevent steam trace iron shine on the fabric to protect garments.
- ◎ Silicon pad that maintains steam pressure
- ◎ Durable quality for long time use
- ◎ More than twice the lifespan of other products thanks to dual fastening and rivet joints

## HEAD OFFICE & FACTORY

EUNSUNG ELECTRIC CO.,LTD  
104-5,SHINPYUNG-RI,SHINBUK-MYON, POCHUN-SI, KYUNGGI-  
DO,KOREA  
TEL: 82-31-531-8131~6 FAX : 82-31-531-8130  
E-MAIL: silverstar@silverstar.co.kr

JIAXING EUNSUNG ELECTRIC CO.,LTD.  
MU YANG ROAD 349# ECONOMIC DEVELOPMENT ZONE  
JIAXING ZHEJIANG CHINA  
TEL: 86-573-8222-4373 FAX: 86-573-8222-4391  
E-MAIL:silverstar@silverstar.co.kr



[www.silverstar.co.kr](http://www.silverstar.co.kr)